



CATALOGUE

2025



ARTE Lamp is an Italian brand with a rich 30-year-old history. We try to keep up with the times and follow modern trends.

**ARTE Lamp** is the impersonation of an assortment's variety and Italian quality, trends and tendency. Strict laconic lines, trendy colors, modern models are the personification of **ARTE Lamp**.

# ARTE Lamp

# History

The illustrations in the catalog  
were created by the tools  
of the **#Midjourney**

**Midjourney** — is an independent  
research laboratory that studies  
new ways of thinking and expands  
the creative abilities of mankind



# Outdoor

all illustrations are created by neural network  
#Midjourney

# NEW YORK



Fixture material: metal painted  
 Fixture colour: black  
 Shade material: metal painted  
 Shade colour: black

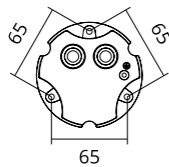

**A1645PA-1BK**

↓ 45 Ø9  
 ♀ 10W | LED, 350LM,  
 4000K, CRI/RA≥80

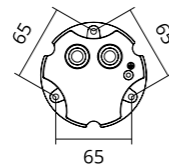

**A1660PA-1BK**

↓ 60 Ø9  
 ♀ 10W | LED, 350LM,  
 4000K, CRI/RA≥80

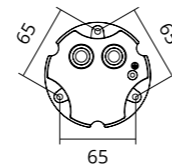

**A1680PA-1BK**

↓ 80 Ø9  
 ♀ 10W | LED, 350LM,  
 4000K, CRI/RA≥80

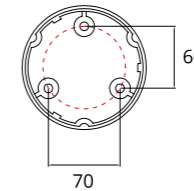

**NEW**  
**A6471FN-1BK**

↓ 15 Ø12  
 ♀ 12W | LED, 400LM,  
 4000K, CRI/RA≥80

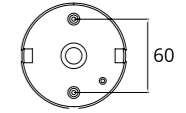

**NEW**  
**A6471PA-1BK**

↓ 80 Ø12  
 ♀ 12W | LED, 400LM,  
 4000K, CRI/RA≥80



# ISTANBUL

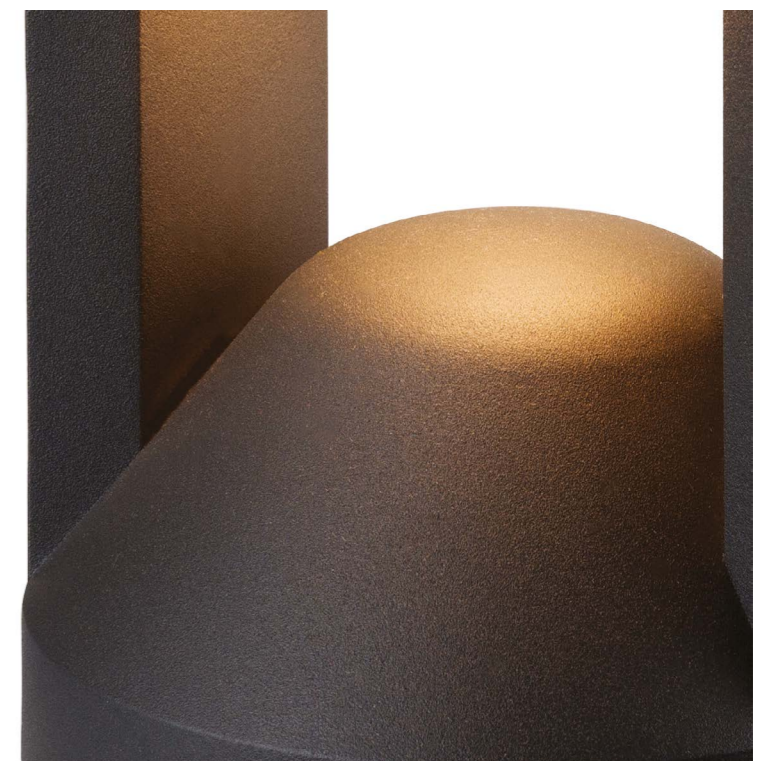

Fixture material: aluminum  
 Fixture colour: black  
 Shade material: aluminum, glass  
 Shade colour: black

OUTDOOR

NEW YORK | ISTANBUL



**NEW**

**A6406PF-1BK**

↓ 11 ↔ 16 ↗ 16  
 ∅ 15W | LED, 1200LM,  
 3000/4500/6500K, CRI/RA≥80



**NEW**

**A6206PF-1BK**

↓ 11 ∅ 17  
 ∅ 15W | LED, 1200LM,  
 3000/4500/6500K, CRI/RA≥80



Fixture material: aluminum / pc  
 Fixture colour: black  
 Shade material: pc  
 Shade colour: white



**NEW**

**A1331AL-1BK**

↓ 24 ↔ 8 ↗ 15  
 ∅ 12W | LED, 960LM,  
 4000K, CRI/RA≥80



Fixture material: aluminum  
 Fixture colour: black  
 Shade material: aluminum, pc  
 Shade colour: white



**NEW**

**A1332AL-1BK**

↓ 24 ↔ 10 ↗ 15  
 ∅ 12W | LED, 960LM,  
 4000K, CRI/RA≥80



# MENKAR

# SALIRE

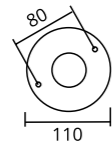

**NEW**

**A3157AL-1BK**

↑ 40 ↔ 8 ↗ 20  
♀ 20W | E27

IP44

Fixture material: stainless steel / metal painted  
Fixture colour: satin silver / black  
Shade material: pc  
Shade colour: white

**NEW**

**A3157PA-1BK**

↑ 100 Ø 8  
♀ 20W | E27  
▽ 11

IP44



**A3157PA-1SS**

↑ 100 Ø 8  
♀ 20W | E27  
▽ 11

IP44

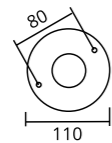

**NEW**

**A3158PA-1BK**

↑ 45 Ø 8  
♀ 20W | E27  
▽ 11

IP44



**A3158PA-1SS**

↑ 45 Ø 8  
♀ 20W | E27  
▽ 11

IP44



**A1631PA-1BK**

↑ 45 ↔ 12 ↗ 12  
♀ 60W | E27

IP54

Fixture material: metal painted  
Fixture colour: black  
Shade material: glass  
Shade colour: clear



**A1631FN-1BK**

↑ 25 ↔ 12 ↗ 12  
♀ 60W | E27

IP54



**A1631AL-1BK**

↑ 25 ↔ 12 ↗ 13  
♀ 60W | E27

IP54

# POT

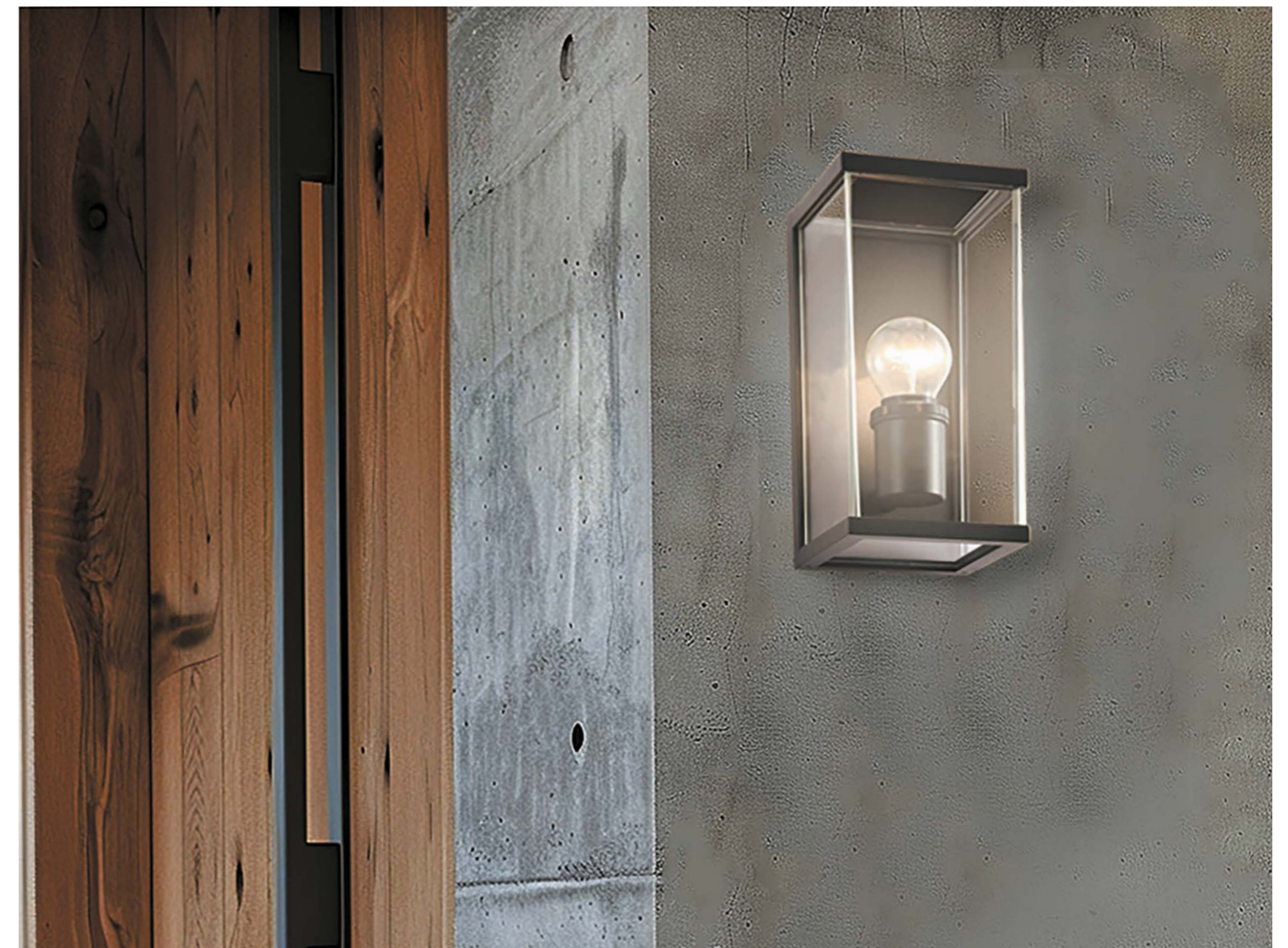

OUTDOOR

SALIRE | POT



**NEW**  
A4569AL-1BR  
↑ 26 ↔ 10 ↗ 15  
♀ 60W | E27

IP44



A4569AL-1BK  
↑ 26 ↔ 10 ↗ 15  
♀ 60W | E27

IP44



A4569AL-2BK  
↑ 37 ↔ 10 ↗ 15  
♀ 2X60W | E27

IP44



A1036PA-1BK  
↑ 100 ∅ 13  
♀ 40W | E27

IP54

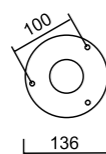

A1036FN-1BK  
↑ 34 ∅ 13  
♀ 40W | E27

IP54

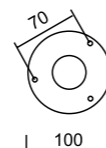

A1036AL-1BK  
↑ 29 ↔ 13 ↗ 18  
♀ 40W | E27

IP54

Fixture material: metal painted  
Fixture colour: black  
Shade material: glass  
Shade colour: clear



**NEW**  
A4569AL-2BR  
↑ 37 ↔ 10 ↗ 15  
♀ 2X60W | E27

IP44

Fixture material: metal painted  
Fixture colour: black / brown  
Shade material: glass  
Shade colour: clear

# BELFAST





# BELFAST



## A4569SO-1BK

↓ 33 ↔ 15 ↗ 15  
 ♀ 60W | E27  
 ⚡ 80 ∇ 11

IP44



## NEW A2146PA-1BR

↓ 60 ↔ 8 ↗ 17  
 ♀ 30W | LED, 1200LM,  
 4000K, CRI/RA≥80

incl IP65

## NEW A2146PA-1BK

↓ 60 ↔ 8 ↗ 17  
 ♀ 30W | LED, 1200LM,  
 4000K, CRI/RA≥80

incl IP65



## NEW A2148PA-1BR

↓ 80 ↔ 8 ↗ 17  
 ♀ 30W | LED, 1200LM,  
 4000K, CRI/RA≥80

incl IP65

## NEW A2148PA-1BK

↓ 80 ↔ 8 ↗ 17  
 ♀ 30W | LED, 1200LM,  
 4000K, CRI/RA≥80

incl IP65



## NEW A4569FN-1BK

↓ 50 ↔ 15 ↗ 15  
 ♀ 60W | E27  
 ∇ 12X12

IP44



## A4569PF-2BK

↓ 13 ↔ 29 ↗ 29  
 ♀ 2X60W | E27

IP44



## NEW A2140PA-1BR

↓ 230 ↔ 8 ↗ 17  
 ♀ 30W | LED, 1200LM,  
 4000K, CRI/RA≥80

incl IP65

## NEW A2140PA-1BK

↓ 230 ↔ 8 ↗ 17  
 ♀ 30W | LED, 1200LM,  
 4000K, CRI/RA≥80

incl IP65

# ARNEB



Fixture material: aluminum  
 Fixture colour: black / brown  
 Shade material: aluminum  
 Shade colour: black

Fixture material: metal painted  
 Fixture colour: black / brown  
 Shade material: glass  
 Shade colour: clear

OUTDOOR

BELFAST | ARNEB



**NEW**  
A1910PA-1BK  
↓ 80 ↔ 10 ↗ 18  
♀ 9W | GX53  
▽ 10



**NEW**  
A1910PA-2BK  
↓ 80 ↔ 10 ↗ 27  
♀ 2X9W | GX53  
▽ 10



Fixture material: metal painted  
Fixture colour: black  
Shade material: pc  
Shade colour: clear / black



A1910PF-1BK  
↓ 10 Ø 10  
♀ 9W | GX53  
▽ 10



A1910AL-1BK  
↓ 14 ↔ 10 ↗ 12  
♀ 9W | GX53



A1910AL-2BK  
↓ 18 ↔ 10 ↗ 12  
♀ 2X9W | GX53



A3710AL-1BK  
↓ 24 ↔ 9 ↗ 11  
♀ 15W | E27



\* PIR sensor incl



A3711AL-1BK  
↓ 24 ↔ 9 ↗ 13  
♀ 15W | E27



2x power sockets incl.



A3711PA-1BK  
↓ 42 ↔ 9 ↗ 11  
♀ 15W | E27



Fixture material: metal painted  
Fixture colour: black  
Shade material: PC  
Shade colour: white



A3710PA-1BK  
↓ 100 ↔ 9 ↗ 9  
♀ 15W | E27



**NEW**  
A3711FN-1BK  
↓ 80 ↔ 9 ↗ 9  
♀ 15W | E27  
▽ 13X13



PLATE





Fixture material: pc  
 Fixture colour: black  
 Shade material: pc  
 Shade colour: black



**NEW**  
**A6109AL-1BK**  
 ↓ 12 ↔ 8 ↗ 10  
 ∅ 9W | LED, 800LM,  
 3000/4500/6500K, CRI/  
 RA≥80  
 ∇ 6,5X5



**NEW**  
**A6109AL-2BK**  
 ↓ 16 ↔ 8 ↗ 10  
 ∅ 2X9W | LED, 1600LM,  
 3000/4500/6500K, CRI/  
 RA≥80  
 ∇ 6,5X5



**NEW**  
**A1807AL-1BK**  
 ↓ 13 ↔ 6 ↗ 9  
 ∅ 7W | LED, 500LM,  
 4000K, CRI/RA≥80  
 ∇ 8X5



**NEW**  
**A1813AL-1BK**  
 ↓ 18 ↔ 10 ↗ 12  
 ∅ 13W | LED, 1150LM,  
 4000K, CRI/RA≥80  
 ∇ 10X6



**NEW**  
**A1807AL-2BK**  
 ↓ 17 ↔ 6 ↗ 9  
 ∅ 2X7W | LED, 1000LM,  
 4000K, CRI/RA≥80  
 ∇ 8X5



**NEW**  
**A1813AL-2BK**  
 ↓ 26 ↔ 10 ↗ 12  
 ∅ 2X13W | LED, 2350LM,  
 4000K, CRI/RA≥80  
 ∇ 10X6



**NEW**  
**A1807PF-1BK**  
 ↓ 10 ∅ 6  
 ∅ 7W | LED, 500LM,  
 4000K, CRI/RA≥80



**NEW**  
**A1813PF-1BK**  
 ↓ 13 ∅ 10  
 ∅ 13W | LED, 1150LM,  
 4000K, CRI/RA≥80



Fixture material: aluminum  
 Fixture colour: black  
 Shade material: aluminum  
 Shade colour: black

# TORCULAR



# COMPASS



Fixture material: metal painted / aluminum, glass  
 Fixture colour: black  
 Shade material: metal painted  
 Shade colour: black



**A3102AL-1BK**

↓ 8 ↔ 7 ↗ 9  
 ∅ 35W | GU10

IP65



**A3102AL-2BK**

↓ 15 ↔ 7 ↗ 9  
 ∅ 2X35W | GU10

IP65



**A3102FN-1BK**

↓ 50 ↔ 7 ↗ 12  
 ∅ 35W | GU10

IP65

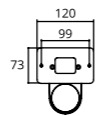

**A3102PA-1BK**

↓ 100 ↔ 7 ↗ 12  
 ∅ 35W | GU10

IP65

# CALAMARO

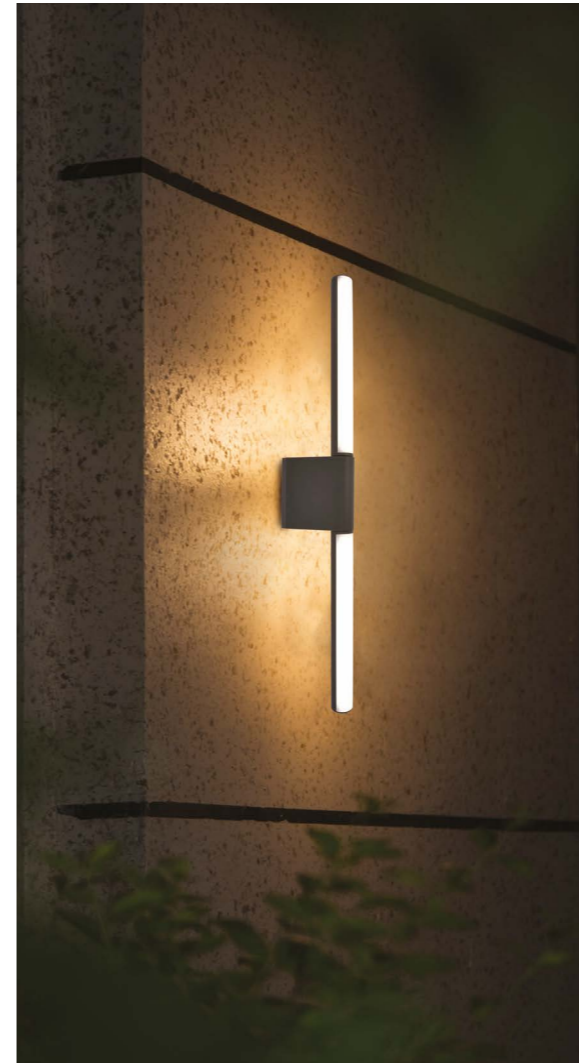

NEW

**A5191AL-2BK**

↓ 55 ↔ 8 ↗ 10  
 ∅ 2X6W | LED, 1000LM,  
 4000K, CRI/RA≥80



Fixture material: aluminum  
 Fixture colour: black  
 Shade material: pc  
 Shade colour: white

# ATMOS



NEW

**A5409AL-1BK**

↓ 80 ↔ 6 ↗ 10  
 ∅ 9W | LED, 450LM,  
 3000K, CRI/RA  
 ∇ 6



Fixture material: metal painted  
 Fixture colour: black  
 Shade material: pc  
 Shade colour: black

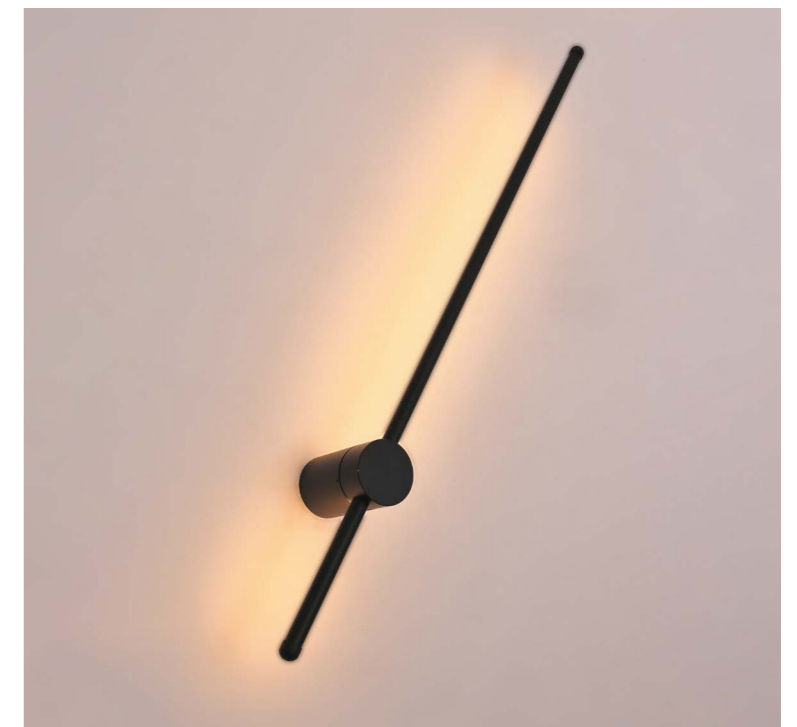

OUTDOOR

COMPASS | CALAMARO | ATMOS

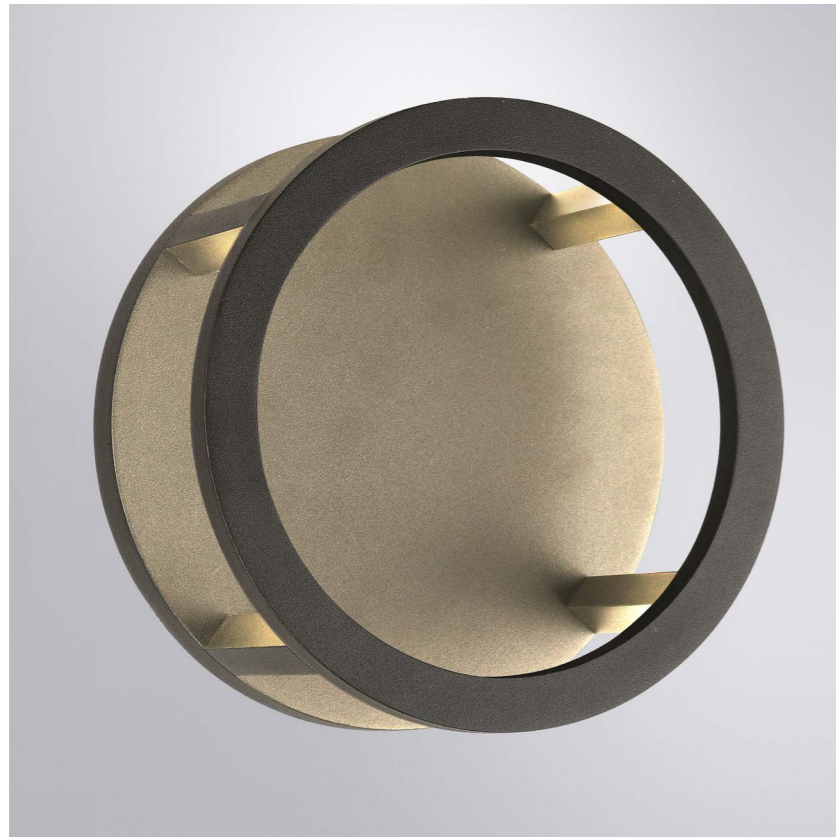

**NEW**

**A3374AL-1BK**

↓ 13 ↔ 9 ↗ 23  
 ♀ 9W | LED, 450LM,  
 4000K, CRI/RA≥80



**NEW**

**A3370AL-1BK**

↓ 13 ∅21  
 ♀ 9W | LED, 450LM,  
 4000K, CRI/RA≥80



Fixture material: aluminum  
 Fixture colour: black / brown  
 Shade material: aluminum  
 Shade colour: black



**NEW**

**A3374AL-1BR**

↓ 13 ↔ 9 ↗ 23  
 ♀ 9W | LED, 450LM,  
 4000K, CRI/RA≥80



**NEW**

**A3370PA-1BK**

↓ 50 ∅21  
 ♀ 9W | LED, 450LM,  
 4000K, CRI/RA≥80



**NEW**

**A3374PA-1BK**

↓ 50 ↔ 9 ↗ 23  
 ♀ 9W | LED, 450LM,  
 4000K, CRI/RA≥80





Fixture material: aluminum  
 Fixture colour: brown / gold / black  
 Shade material: pc  
 Shade colour: clear



**NEW**  
**A2481AL-1BR**

↓ 26 ↔ 9 ↗ 13  
 ♀ 15W | E27

IP65



**NEW**  
**A2481AL-1GO**

↓ 26 ↔ 9 ↗ 13  
 ♀ 15W | E27

IP65

# ARTEFACT

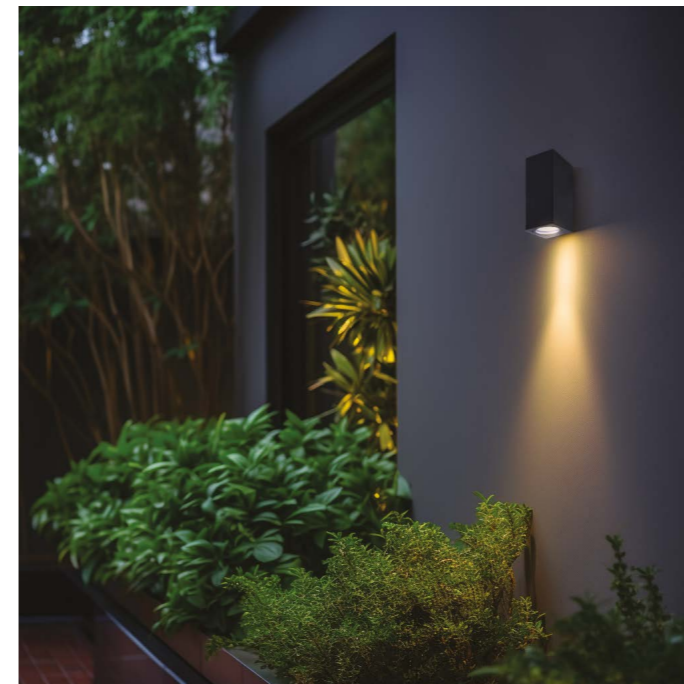

Fixture material: aluminum  
 Fixture colour: black  
 Shade material: aluminum  
 Shade colour: black



**NEW**  
**A3404AL-1BK**

↓ 10 ↔ 7 ↗ 8  
 ♀ 35W | GU10

IP65



**NEW**  
**A3404AL-2BK**

↓ 16 ↔ 7 ↗ 8  
 ♀ 2X35W | GU10

IP65



**NEW**  
**A2322AL-1BR**

↓ 24 ↔ 10 ↗ 14  
 ♀ 15W | E27

IP65



**NEW**  
**A2322AL-1BK**

↓ 24 ↔ 10 ↗ 14  
 ♀ 15W | E27

IP65



**NEW**  
**A2322AL-1GO**

↓ 24 ↔ 10 ↗ 14  
 ♀ 15W | E27

IP65



**NEW**  
**A2313AL-1BK**

↓ 27 ↔ 12 ↗ 15  
 ♀ 15W | LED, 600LM,  
 4000K, CRI/RA≥80

incl IP44

Fixture material:  
 aluminum, metal painted  
 Fixture colour: black  
 Shade material: glass  
 Shade colour: clear

# ATLANTIS

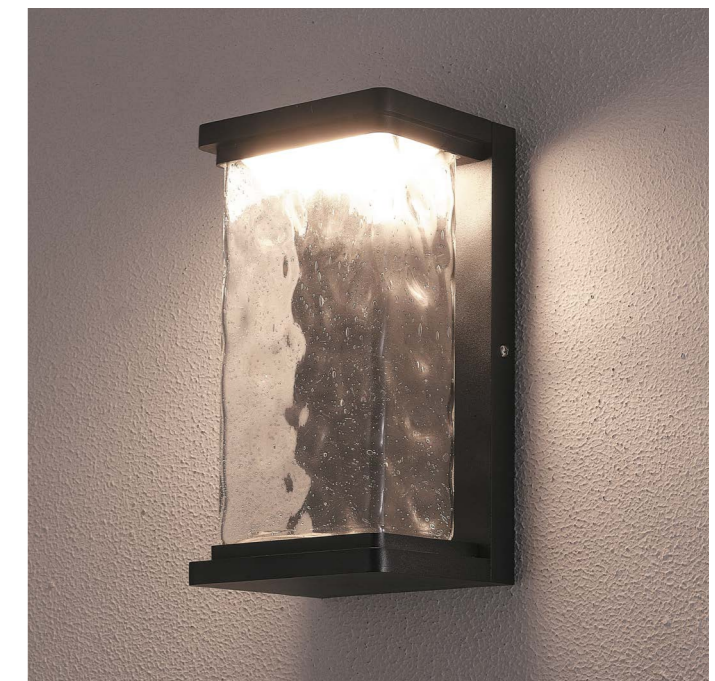



**A3304AL-1WH**

↓ 15 ↔ 6 ↗ 8  
 ∅ 35W | GU10



**A3304AL-1BK**

↓ 15 ↔ 6 ↗ 8  
 ∅ 35W | GU10



\* PIR sensor incl



**A3302PA-1BK**

↓ 60 ↔ 6 ↗ 12  
 ∅ 35W | GU10



**A3302PA-2BK**

↓ 60 ↔ 6 ↗ 17  
 ∅ 2X35W | GU10



Fixture material: aluminum / metal painted  
 Fixture colour: black / gray / white  
 Shade material: aluminum / metal painted / aluminum, glass  
 Shade colour: black / gray / white



**NEW**  
**A3322AL-1BK**

↓ 15 ↔ 7 ↗ 11  
 ∅ 35W | GU10



**NEW**  
**A3322AL-2BK**

↓ 21 ↔ 7 ↗ 11  
 ∅ 2X35W | GU10



**A3302AL-2WH**

↓ 17 ↔ 6 ↗ 11  
 ∅ 2X35W | GU10



**A3302AL-2GY**

↓ 17 ↔ 6 ↗ 11  
 ∅ 2X35W | GU10



**A3302AL-2BK**

↓ 17 ↔ 6 ↗ 11  
 ∅ 2X35W | GU10



**A3302AL-1WH**

↓ 13 ↔ 6 ↗ 11  
 ∅ 35W | GU10



**A3302PF-1GY**

↓ 10 ∅ 6  
 ∅ 35W | GU10



**A3302AL-1BK**

↓ 13 ↔ 6 ↗ 11  
 ∅ 35W | GU10



**A3303AL-1WH**

↓ 15 ↔ 6 ↗ 10  
 ∅ 35W | GU10



**A3303AL-1GY**

↓ 15 ↔ 6 ↗ 10  
 ∅ 35W | GU10



**A3303AL-1BK**

↓ 15 ↔ 6 ↗ 10  
 ∅ 35W | GU10



**A3302PF-1WH**

↓ 10 ∅ 6  
 ∅ 35W | GU10



**A3302AL-1GY**

↓ 13 ↔ 6 ↗ 11  
 ∅ 35W | GU10



**A3302PF-1BK**

↓ 10 ∅ 6  
 ∅ 35W | GU10





**A1831AL-1BK**

↓ 7 ↔ 16 ↗ 19  
 ♀ 7W | LED, 550LM,  
 4000K, CRI/RA≥80



**A1831PA-1BK**

↓ 70 ↔ 7 ↗ 16  
 ♀ 7W | LED, 550LM,  
 4000K, CRI/RA≥80



Fixture material: metal painted  
 Fixture colour: black  
 Shade material: PC  
 Shade colour: white

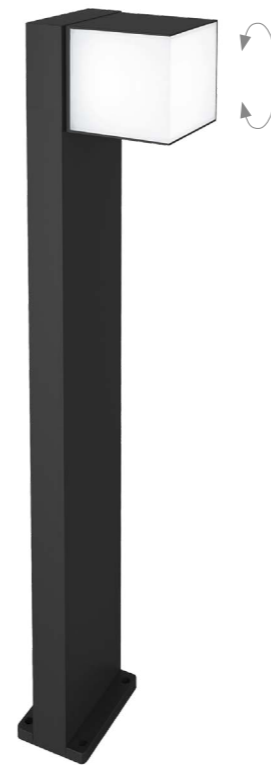

**NEW**

**A5193PA-1BK**

↓ 75 ↔ 10 ↗ 14  
 ♀ 12W | LED, 500LM,  
 4000K, CRI/RA≥80



Fixture material: aluminum  
 Fixture colour: black  
 Shade material: pc  
 Shade colour: white

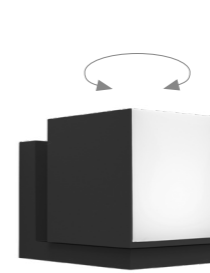

**NEW**

**A5193AL-1BK**

↓ 12 ↔ 10 ↗ 15  
 ♀ 12W | LED, 500LM,  
 4000K, CRI/RA≥80



**NEW**

**A5193AL-2BK**

↓ 21 ↔ 10 ↗ 15  
 ♀ 2X12W | LED, 1000LM,  
 4000K, CRI/RA≥80



# BELGRADE







**A6218PA-1BK**

↑ 80 ∅ 9  
 ♀ 40W | E27

IP54



**A6218FN-1BK**

↑ 30 ∅ 9  
 ♀ 40W | E27

IP54



**A6218AL-1BK**

↑ 25 ↔ 9 ↗ 15  
 ♀ 40W | E27

IP54

Fixture material: metal painted  
 Fixture colour: black  
 Shade material: glass  
 Shade colour: smoky



**A6215PA-1BK**

↑ 50 ∅ 9  
 ♀ 40W | E27

IP54



**NEW**  
**A1328PA-1BK**

↑ 80 ↔ 8 ↗ 14  
 ♀ 9W | LED, 420LM,  
 4000K, CRI/RA≥80

incl IP54

Fixture material: aluminum  
 Fixture colour: black  
 Shade material: aluminum  
 Shade colour: white



**NEW**  
**A1326AL-1BK**

↑ 11 ↔ 8 ↗ 14  
 ♀ 9W | LED, 420LM,  
 4000K, CRI/RA≥80

incl IP54



**NEW**  
**A1326PA-1BK**

↑ 50 ↔ 8 ↗ 14  
 ♀ 9W | LED, 420LM,  
 4000K, CRI/RA≥80

incl IP54

# LIVERPOOL





Fixture material: aluminum  
 Fixture colour: black  
 Shade material: aluminum  
 Shade colour: black

**NEW**  
**A1646PA-1BK**  
 ↓ 50 ↔ 12 ↗ 15  
 ♀ 13W | LED, 640LM,  
 4000K, CRI/RA≥80



**NEW**  
**A1648PA-1BK**  
 ↓ 80 ↔ 12 ↗ 15  
 ♀ 13W | LED, 640LM,  
 4000K, CRI/RA≥80



**NEW**  
**A2728PA-1BK**  
 ↓ 80 ↔ 11 ↗ 11  
 ♀ 9W | LED, 550LM,  
 4000K, CRI/RA≥80



Fixture material: aluminum  
 Fixture colour: black  
 Shade material: aluminum  
 Shade colour: black



**NEW**  
**A2726AL-1BK**  
 ↓ 25 ↔ 11 ↗ 15  
 ♀ 9W | LED, 550LM,  
 4000K, CRI/RA≥80



**NEW**  
**A2726PA-1BK**  
 ↓ 60 ↔ 11 ↗ 11  
 ♀ 9W | LED, 550LM,  
 4000K, CRI/RA≥80



**PHERKAD**





Fixture material: stainless steel, aluminum  
 Fixture colour: satin silver  
 Shade material: glass  
 Shade colour: clear



**A6014IN-1SS**

↓ 20 ↔ 15  
 ♀ 60W | E27

IP67



**A6015IN-1SS**

↓ 13 ↔ 11 ↗ 11  
 ♀ 35W | GU10

IP67



**A6017IN-1SS**

↓ 13 ∅ 11  
 ♀ 35W | GU10

IP67

## TIPICO

Fixture material: pc  
 Fixture colour: black  
 Shade material: pc  
 Shade colour: white



**NEW**  
**A1505IN-1BK**

↓ 9 ↔ 6 ↗ 23  
 ♀ 5W | LED, 300LM,  
 3000/4500/6500K, CRI/RA≥80

incl IP65



**NEW**  
**A1505AL-1BK**

↓ 8 ↔ 3 ↗ 23  
 ♀ 5W | LED, 300LM,  
 3000/4500/6500K, CRI/RA≥80

incl IP65

## FERRO



**NEW**  
**A5224AL-1BK**

↓ 13 ↔ 10 ↗ 32  
 ♀ 24W | LED, 2000LM,  
 3000/4500/6500K, CRI/RA≥80

incl IP65



**NEW**  
**A2920AL-1BK**

↓ 13 ↔ 13 ↗ 26  
 ♀ 20W | LED, 1500LM,  
 4000K, CRI/RA≥80

incl IP65

Fixture material: pc  
 Fixture colour: black  
 Shade material: pc  
 Shade colour: white

## ELSIE



**NEW**  
**A1127IN-1BK**

↓ 20 ↔ 6 ↗ 7  
 ♀ 7W | LED, 700LM,  
 4000K, CRI/RA≥80

PC incl IP65

Fixture material: plastic / aluminum / pc  
 Fixture colour: black  
 Shade material: plastic / aluminum, glass / pc  
 Shade colour: black



**NEW**  
**A1127AL-1BK**

↓ 7 ↔ 6 ↗ 12  
 ♀ 7W | LED, 700LM,  
 4000K, CRI/RA≥80

PC incl IP65

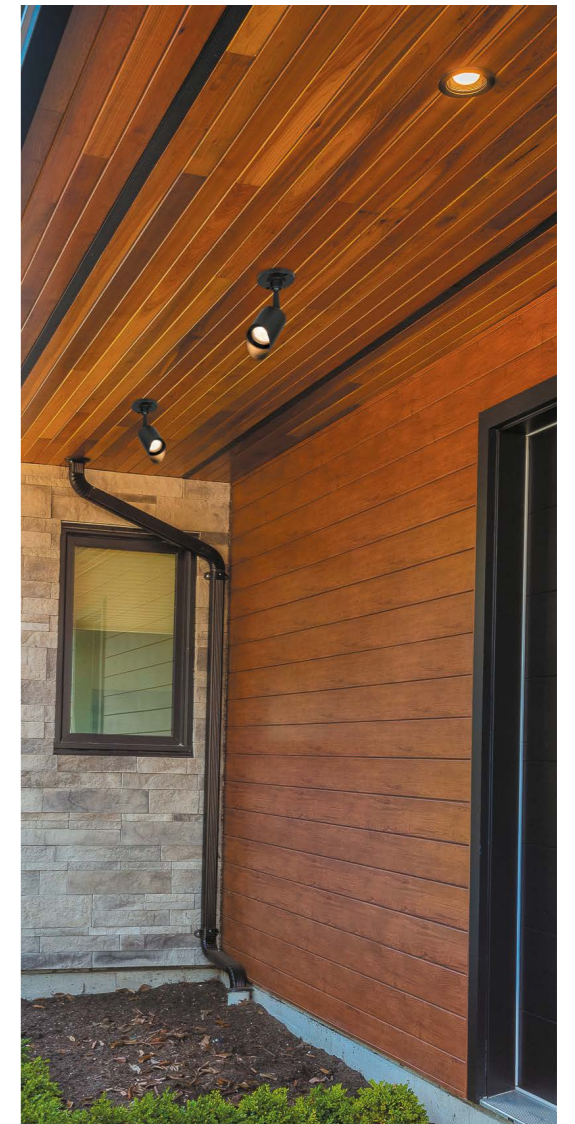

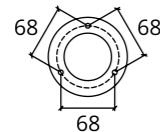

**NEW**  
A2063PA-1BK

↑ 67 ↔ 6 ↗ 9  
♀ 35W | GU10  
▽ 10



**NEW**  
A2063PA-2BK

↑ 67 ↔ 6 ↗ 9  
♀ 2X35W | GU10  
▽ 10



**NEW**  
A2063AL-1BK

↑ 10 ↔ 9 ↗ 14  
♀ 35W | GU10  
▽ 10



Fixture material: aluminum  
Fixture colour: black  
Shade material: aluminum  
Shade colour: black

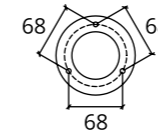

**NEW**  
A2362AL-2BK

↑ 21 ↔ 9 ↗ 20  
♀ 10W/12W | GU10/GX53  
▽ 8



Fixture material: aluminum  
Fixture colour: black  
Shade material: pc  
Shade colour: white



**NEW**  
A2360AL-2BK

↑ 21 ↔ 9 ↗ 20  
♀ 10W/12W | GU10/GX53  
▽ 8



**NEW**  
A2360AL-2BK

↑ 21 ↔ 9 ↗ 20  
♀ 10W/12W | GU10/GX53  
▽ 8



BUDAPEST





NEW

A2367AL-1BK

↑ 30 ↔ 8 ↗ 14  
 ♀ 35W | GU10  
 ∇ 8

IP54

NEW

A2367PA-1BK

↑ 63 ↔ 8 ↗ 18  
 ♀ 35W | GU10  
 ∇ 10

IP54

Fixture material: aluminum  
 Fixture colour: black  
 Shade material: aluminum  
 Shade colour: black

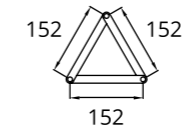

NEW

A4109FN-1BK

↑ 60+20 ↔ 6 ↗ 7,5  
 ♀ 6W | LED, 620LM,  
 3000K, CRI/RA≥80

incl IP65

NEW

A4109PA-2BK

↑ 130 ↔ 10 ↗ 36  
 ♀ 2X6W | LED, 1200LM,  
 3000K, CRI/RA≥80  
 ∇ 20

incl IP65

Fixture material: aluminum  
 Fixture colour: black  
 Shade material: aluminum, glass  
 Shade colour: black

MUPHRID





**A2802AL-1GY**

↓ 21 ↔ 17 ↗ 13  
 ⌀ 60W | E27

IP54



**A2802AL-1BK**

↓ 21 ↔ 17 ↗ 13  
 ⌀ 60W | E27

IP54



**A2801AL-1GY**

↓ 13 ↔ 17 ↗ 10  
 ⌀ 60W | E27

IP54



**A2801AL-1BK**

↓ 13 ↔ 17 ↗ 10  
 ⌀ 60W | E27

IP54

Fixture material: aluminum  
 Fixture colour: black / gray  
 Shade material: glass  
 Shade colour: clear



**NEW**  
**A9050AL-1BK**

↓ 5 ↔ 14 ↗ 26  
 ⌀ 5W | LED, 500LM,  
 6500K, CRI/RA≥80  
 ∇ 10X9

incl. IP65



**NEW**  
**A9100AL-1BK**

↓ 5 ↔ 20 ↗ 32  
 ⌀ 10W | LED, 900LM,  
 6500K, CRI/RA≥80  
 ∇ 10X9

incl. IP65



**NEW**  
**A9400AL-1BK**

↓ 5 ↔ 23 ↗ 66  
 ⌀ 40W | LED, 2500LM,  
 6500K, CRI/RA≥80  
 ∇ 10X9

incl. IP65



Fixture material: pc  
 Fixture colour: black  
 Shade material: glass  
 Shade colour: black

# AVIOR

- unique technology of self-charging solar panel during work increases the lamp work to 20% to regular solar panels
- remote control, installation bracket and all necessary accessories incl
- high ingress protection level: IP68 for the panel and IP65 for the battery space
- 4 optional work modes, applicable to different places/weathers
- automatic start working within darkness
- automatic high-light at movement detection within 8-10m for 15 sec
- automatic low-light (10% of high-power) at no movement
- batteries long span life: over 1000 of charge-discharge cycles
- full charged operating time: 8 hh
- high-quality UV-high-resistant ABS-material housing



# ITEM DESIGNATIONS

		
<b>AP</b>	applique	wall lamp
<b>AL</b>	applique strada	outdoor wall lantern
<b>FN</b>	colonna strada piccolo	outdoor stand lantern
<b>IN</b>	incorporabile	recessed
<b>LM</b>	lampadario	chandelier
<b>LT</b>	lampada da tavolo	table lamp
<b>PA</b>	colonna strada grande	outdoor pole lantern
<b>PF</b>	plafoniera strada	outdoor flush lantern
<b>PL</b>	plafoniera	flush
<b>PN</b>	pavimento	floor lamp
<b>SO</b>	sospeso strada	outdoor pendant lantern
<b>SP</b>	sospeso	pendant

















The Company reserves the right to typos, errors and corrections of technical information.

The manufacturer has the right, without prior notice, to make changes to the product that do not worsen its technical characteristics, but are the result of work to improve its design or production technology. The appearance of the goods may differ from the photographic materials presented in the catalog due to the peculiarities of printing and color perception by the human eye, and may also vary slightly from batch to batch.

# COLORS

					
	COLORI	COLOURS	COLORIS	FARBEN	KOLORY
AB	bronzo antico	antique bronze	antique bronze	antik bronze	antyczny brąz
AC	rame antico	antique copper	civre antique	antikes kupfer	antyczna miedź
AZ	azzurro	azure	azure	blau	niebieski
AM	ambra	amber	ambre	bernstein	bursztyn
BA	nero antico	antique black	antique noir	antik schwarz	antyczny czarny
BC	cromo nero	black chrome	chrome noir	schwarzes chrom	czarny chrom
BG	rame vecchio	old brass	vieux cuivre	alte kupfer	stara miedź
BJ	beige	beige	beige	beige	beżowy
BK	nero	black	noir	schwarz	czarny
BL	blu	blue	bleu	blau	niebieski
BN	nero dorato	black gold	noire or	schwarz gold	czarny-złoto
BR	marrone	brown	brun	braun	brązowy
BS	argento nero	black silver	noire argent	schwarz silber	czarne srebro
BZ	bronzo	bronze	bronze	bronze	brąz
CC	cromo	chrome	chrome	chrom	chrom
CG	cognac	cognac	cognac	cognac	koniak
CK	cioccolato	chocolate	chocolat	schokolade	czekolada
CL	transparent	clear	clair	transparent	przezroczysty
CR	crema	cream	crème	sahne	krem
GA	oro antico	antique gold	antique or	antik gold	antyczne złoto
GO	oro	gold	or	gold	złoto
GR	verde	green	vert	grün	zielony
GY	grigio	grey	grises	grau	szary
MG	lilla	magenta	lilas	lila	liliowy
OR	arancione	orange	orange	orange	pomarańczowy
PB	rame levigato	polished brass	laiton poli	poliert kupfer	miedź polerowana
PK	rosa	pink	rose	rosa	różowy
PR	perla	pearl	perle	perle	perła
RB	bronzo rosso	red bronze	rouges bronze	rot bronze	czerwony brąz
RD	rosso	red	rouge	rot	czerwony
RI	ferro vecchio	old iron	vieux fer	alt eisen	stare żelazo
SA	argento antico	antique silver	antique argent	antik silber	antyczne srebro
SB	argento niellato	nielloed silver	argent niellè	silber schwarz	srebro czarne
SG	oro opaco	matt gold	mat or	mattiert gold	matowe złoto
SI	argento	silver	argent	silber	srebrny
SM	fumoso	smoky	enfumé	rauchig	dymny
SR	ottone opaco	satin brass	laiton mat	messing-matt	matowa mosiądz
SS	argento opaco	satin silver	nickel mat	silber-matt	matowe srebro
VL	viola	violet	violet	violett	fioletowy
WA	bianco antico	antique white	antique blanc	antik weiß	antyczny biały
WC	bianco crema	cream white	crème blanc	creme weiß	kremowy biały
WG	oro bianco	white gold	blanche or	weiß gold	biało-złoty
WH	bianco	white	blanc	weiß	biały
WS	argento bianco	white silver	blanc-argenté	weiß-silber	biało-srebrny
YL	giallo	yellow	jaune	gelb	żółty

# SYMBOLS DESCRIPTION

- |   |   |   |                     |
|---|---|---|---------------------|
|    | hook fastening provided                 |    | adjustable fitting  |
|    | bracket fastening provided              |    | remote control      |
|    | extra bracket with hook                 |    | IP rated            |
|    | 2 way installation (ceiling or pendant) |    | many steps switch   |
|    | separated switching                     |    | app control         |
|   | dimmer switch included                  |   | touch switch        |
|  | switch included for wall lamps only     |  | bulb included       |
|  | PIR sensor incl                         |  | ceiling bowl / base |

# DIMENSIONS DESCRIPTION

**A 4075 LM - 2 AB**

Arte Series Lamp type Holders Colour

